

CUS150M Open Frame

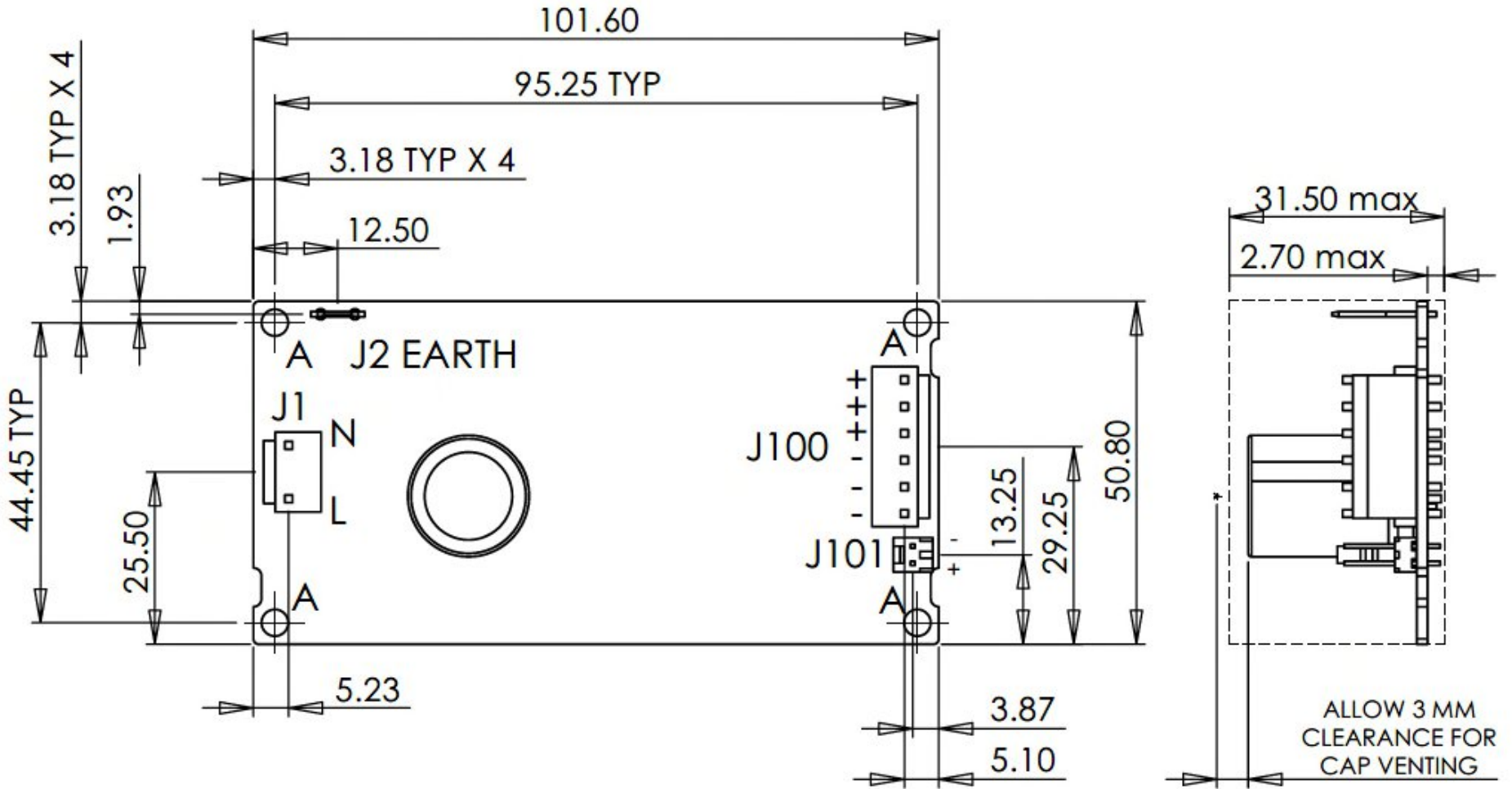

CUS150M/U: U Channel

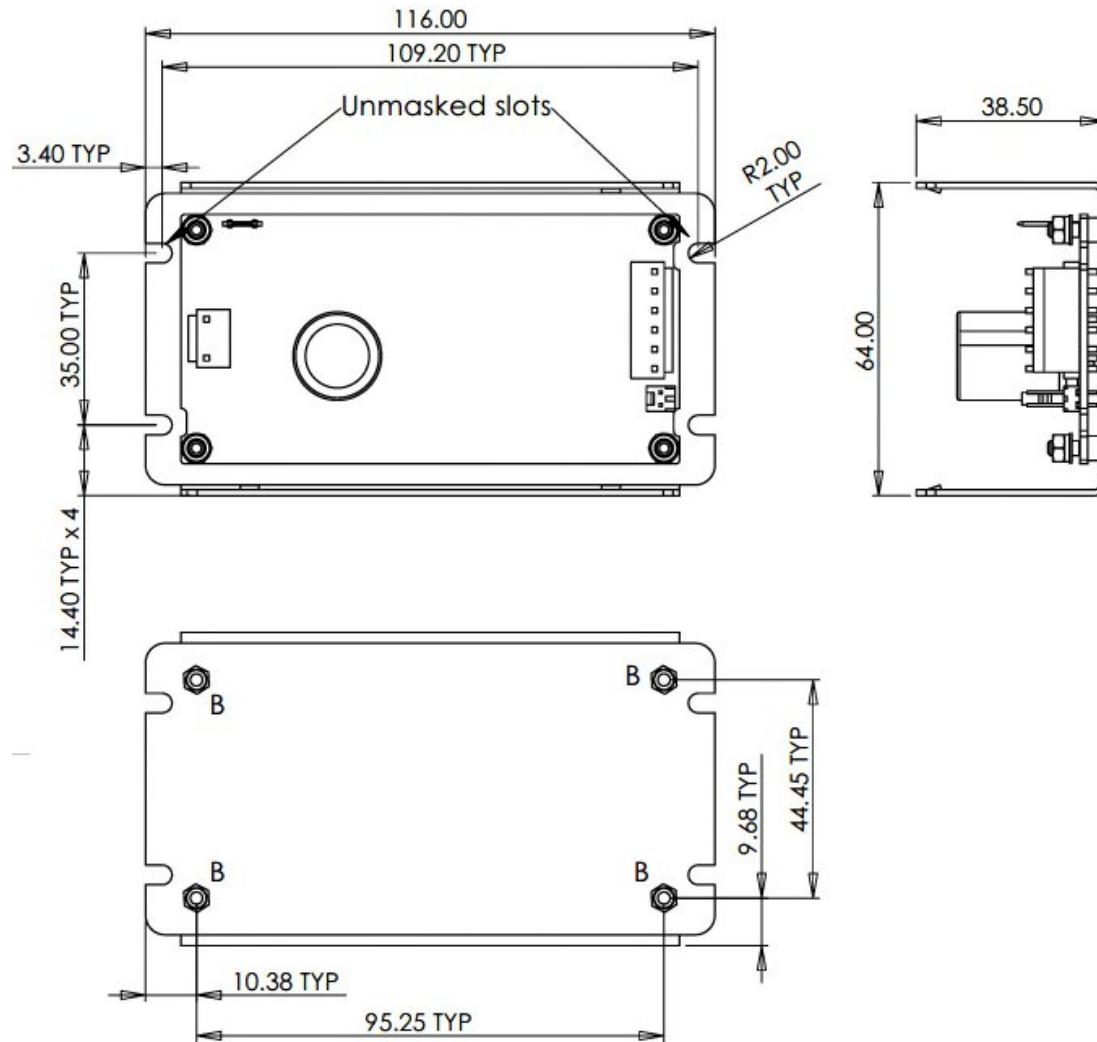

NOTE: B - 4 OFF M3 FIXING - max thread penetration 4.25 mm
RECOMMENDED TORQUE - M3 - 0.5 - 0.6 Nm

CUS150M/A: U Channel with Cover

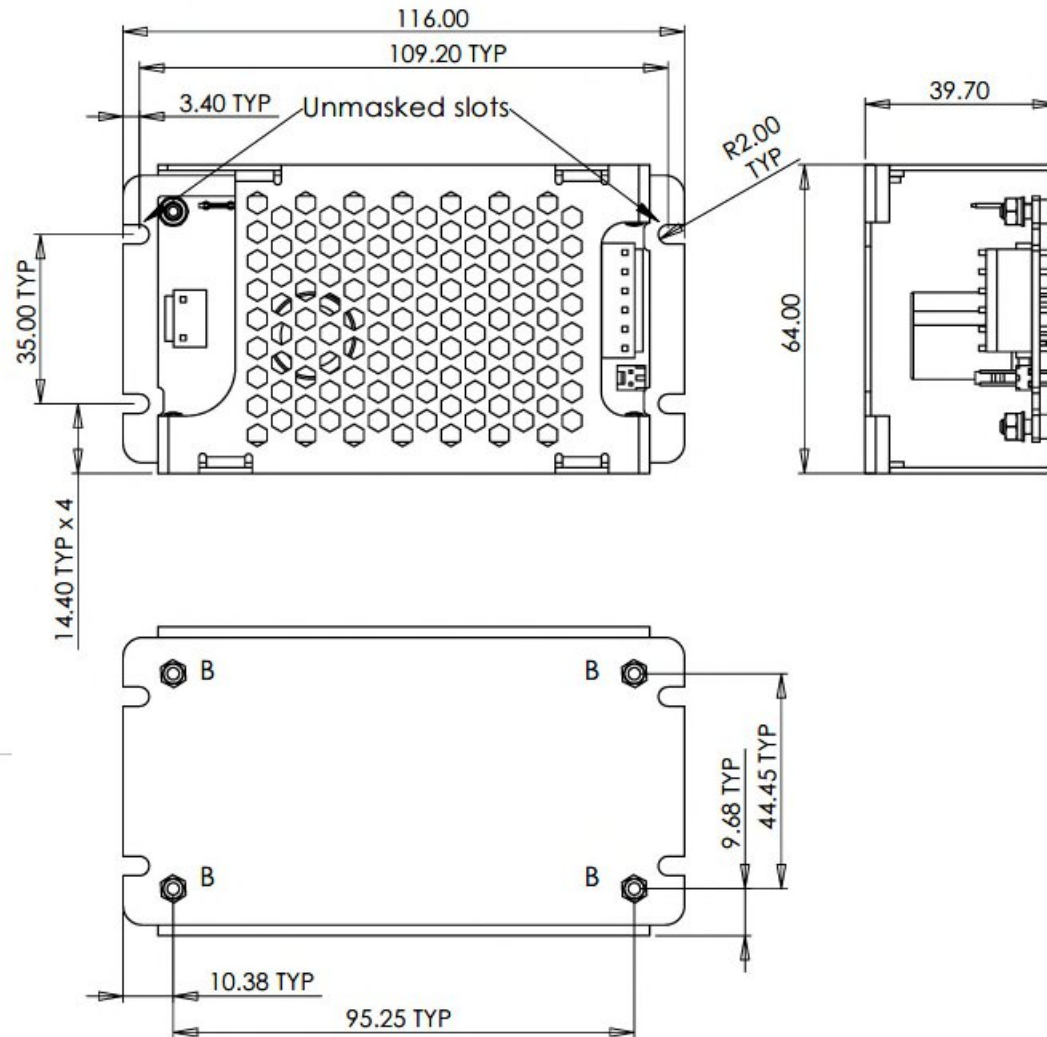

NOTE: B - 4 OFF M3 FIXING - max thread penetration 4.25 mm
RECOMMENDED TORQUE - M3 - 0.5 - 0.6 Nm

CUS150M/F: U Channel with Fan

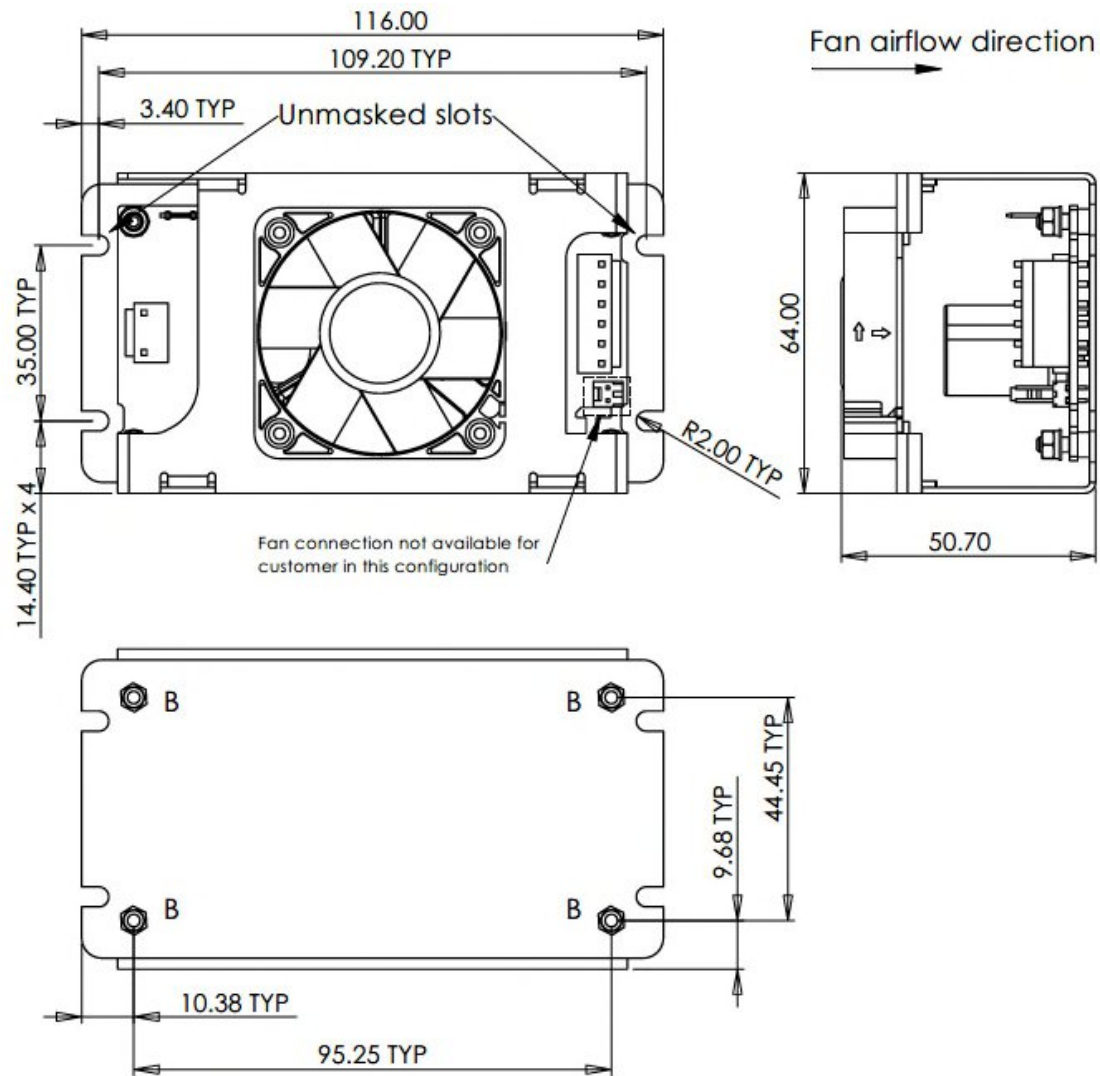

NOTE: B - 4 OFF M3 FIXING - max thread penetration 4.25 mm
RECOMMENDED TORQUE - M3 - 0.5 - 0.6 Nm